

F Driver Free Installation

- 1** Plug the Driver free Adapter into the computer's USB port

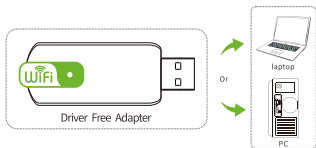

Note: When using the PC, it is recommended to insert the adapter on the back of the computer case, the effect is better!
(The USB interface on the front of most desktop computers is insufficient or unavailable)

- 2** Open **【 This PC 】** on the desktop of your computer



- 3** Right mouse button - open the **【 U Disk 】** or **【 CD Disk 】** , Double-click the installation program, and follow the prompts to complete the installation

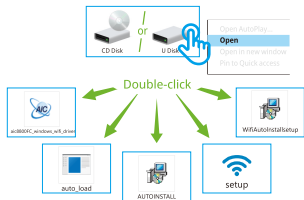

- 4** Click the **WLAN** icon on the taskbar, select and connect to WiFi.

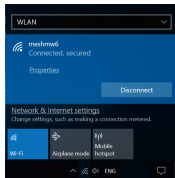

F 快速安装指南

1 把免驱网卡插入电脑USB端口

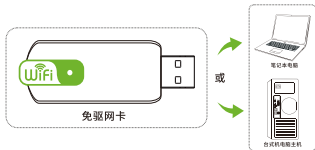

注意：台式机使用时，建议插入电脑机箱后面接口，效果更好！
(大部分台式电脑前面USB接口供电不足或不可使用)

2 在桌面打开【此电脑】



3 鼠标右键-打开【U盘】或【CD盘】磁盘，双击安装程序，按提示完成安装



4 点击任务栏的WLAN图标，选择并连接WiFi。

